



**WATERPROOFING &
BUILDING PRODUCTS**



**COMMERCIAL
PRODUCTS**



**RESIDENTIAL
PRODUCTS**



PRODUCT CATALOG



**Taking the “LEED” on a greener approach to
Waterproofing, Drainage, Insulation and
Building Protection**

Mar-flex Waterproofing Products

Product Catalog

Table of Contents

Commercial

Air & Vapor Barriers	4-5
Air & Vapor Barrier Mastics	6
Flashing	6
Waterproofing.....	7
Foundation Dampproofing.....	8
Drainage & Insulation Board & Drain Tile.....	9-11
Mastics/Concrete Sealer.....	12

Residential & Multi-family

Waterproofing & Dampproofing	13-22
Drainage Board & Drain Tile	23-27
Mastics/Concrete Sealer.....	28
Window Wells, Egress Window Wells.....	29-33

Concrete Products

Control Joint Systems	34
Foundation/Crawl Space Vents	35

Concrete Repair

Crack Injection Repair Kits	36
Concrete Structural Repair Kits	36
Crack Injection Supplies.....	37-38

Equipment

Material Handling	39
Maintenance Kits & Accessories	40-49

Contractor Supplies

Safety	50-51
Cleaning	52
Applicator Items	52

Freight Zones

Order Form



Return Policy

We will normally accept returned products under the following conditions:

- Prior written authorization including RGA number from Mar-flex is obtained
- The products are returned within 30 days from the original date of the invoice
- The products are in new and saleable condition
- A 25% restocking fee plus freight will be added on all returns
- Returns not accepted on electrical replacement parts

Waterproofing and Building Products for Lower Level Living

Improve your bottom line with the best waterproofing products in the industry.

Mar-flex® Waterproofing Products

Mar-flex® waterproofing systems can transform ordinary basements into livable spaces — ideal for a home office, playroom, media room, exercise room and more.

Mar-flex guarantee

Mar-flex guarantees quality and versatility — lower level living spaces that go above and beyond what most people think of as a basement. Mar-flex offers a full range of products to make lower level living possible with everything to perform the job from start to finish.

Complete waterproofing systems

Mar-flex has set the industry standard for offering superior water-based and solvent-based waterproofing membranes, an extensive "Green" product assortment, and a wide range of drainage and insulation boards to complete the job based on your market needs.

Everything you need to do the job right

Mar-flex goes the next step to help you complete the job with product accessories, egress and non-egress window wells, perimeter drainage, telescopic vents and control-joints. Architects and Contractors alike can rely on

Mar-flex for:

- Technical specifications at www.mar-flex.com
- Hands-on training right in your area
- 24/7 job site support
- Equipment installation at your location
- Sales support to help your market
- LEED Certifications
- Specifications and CAD details are available at www.arcat.com

Take Your Lower Level Living to the Next Level



Waterproofing
and Building
Products

Commercial

Air Barrier Systems

AIR Barrier 1200 VP/1200 PRIMER

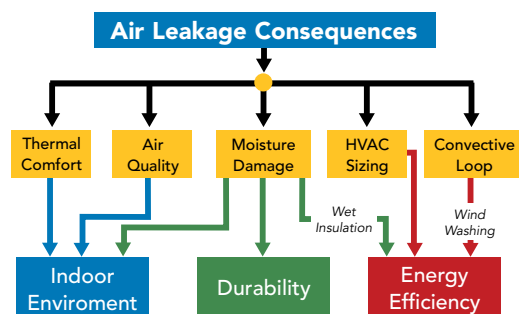

Controlling Air Leakage and Air Flow reduces moisture. It improves indoor air quality and energy efficiency, too.

AIR Barrier 1200 VP Water Based

Mar-flex AIR Barrier 1200 VP vapor permeable air barrier system is designed to stop air infiltration and exfiltration in the building envelope while allowing the transmission of water vapor preventing condensation in the wall assembly. Mar-flex AIR Barrier 1200 VP acrylic membrane adheres fully to CMU, concrete, exterior sheathing and most other building materials.

- Acts as an air and rain barrier
- Allows the diffusion of vapor
- Fluid applied
- Apply to substrate in wall assembly
- Watertight
- Low odor
- Low VOC content
- Can be applied to damp (or green) concrete
- Seals around penetrations and brick ties
- Seamless monolithic membrane



CWAB-12005
5 Gallon Bucket
Each or 36/Pallet



CWAB-120055
55 Gallon Drum
Each or 4/Pallet

Air Barrier1200 VP	
Type	Elastomeric Emulsion Water-Based
Air Leakage	< 0.004 CFM/ft ² ASTM E2178
Vapor Permeance ASTM E96	12.0 Perms
Water-Tightness CGSB 37.58-M86	Pass
Elongation ASTM D412	1200%
UV Exposure	Unlimited
Application Temperature	Minimum 41°F/5°C
Coverage	23-30 ft ² /gal = 30-40 mil dry thickness
Dry Time	12-24 hours
Color	Gray
Application Method	Spray, brush or roller

1200 Primer Water Based

1200 Primer is the primer for the EcoFlash Transition Strip. It is intended to provide a high tack finish to enable the EcoFlash Transition Strip to adhere to various substrates.

- Excellent adhesion – bonds to various substrates
- Water-based
- Color Gray
- Shelf Life 6 months
- Application Method Spray, Brush or Roller



CWPR-12205
5 Gallon Bucket
Each or 36/Pallet



Need Info?
Visit our website!

www.mar-flex.com

AIR and VAPOR Barrier 1800

Different Climates Require Different Barrier Systems. That's Where Mar-flex Air Barriers Excel.

MARINE

The concern is heavy rain and humidity that can become trapped inside wall assemblies.

Air movement and water vapor related problems can occur in all climatic environments.

From bitter cold, to hot and humid, Mar-flex AIR and VAPOR Barrier systems can meet the needs of virtually every climate and building application.



COLD

The concern is warm, moist air that can infiltrate the building envelope & attach to cold surfaces.

MIXED-HUMID

The concern is moisture-laden air that can contact cold surfaces inside and outside.

HOT-HUMID

The concern is moisture-laden air that can infiltrate the building and increase cooling loads.

AIR & VAPOR Barrier 1800 Solvent Based

Mar-flex AIR & VAPOR Barrier 1800 provides a seamless, 100% rubber continuous membrane around the building envelope. It is impermeable to air and vapor transmission. It can be applied directly to a variety of exterior surfaces.

- Acts as an air, vapor and rain barrier
- Very low vapor permeance (less than 0.08 perms)
- Watertight
- Position in wall assembly to prevent moisture condensation
- Low odor
- Can be applied to damp (or green concrete)
- Excellent elongation and recovery
- Seals around penetrations and brick ties
- Seamless monolithic membrane
- Self Priming



CSAV-180055
55 Gallon Drum
Each or 4/Pallet

Air & Vapor Barrier 1800	
Type	100% Rubber Polymer Solvent-Based
Air Leakage	< 0.004 CFM/ft ² ASTM E283
Vapor Permeance ASTM E96	0.08 Perms
Water-Tightness CGSB 37.58-M86	Pass
Elongation ASTM D412	1800%
UV Exposure	30 Days
Application Temperature	Minimum 15°F/-9°C
Coverage	23-30 ft ² /gal = 30-40 mil dry thickness
Dry Time	12 hours
Color	Gray
Application Method	Spray, brush or roller

Mastics/EcoFlash

1800 Mastic Solvent Based

The 1800 Mastic is a single component, hydrocarbon polymer, elastomeric compound. It was designed to be used in conjunction with the 1800 AIR and VAPOR Barrier membrane to fill any cracks or voids in the masonry that will be receiving the membrane.

- Remains flexible during freeze-thaw cycles
- Ready to use
- Color – Gray, Consistency – Rubber coating

Actual coverage rate will vary depending on depth and width of cracks and voids filled. All surfaces should be free from oil, grease, rust, dirt and any other debris. Apply directly to any surface flaw with a trowel or putty knife. Use Mar-flex's Orange 90 cleaner to clean up.

CSMA-18105
5 Gallon Bucket
Each or 36/Pallet



1200 Mastic Water Based

The 1200 Mastic is a hybrid latex emulsion it was designed to be used in conjunction with the 1200 Air Barrier membrane to fill any cracks or voids in the masonry that will be receiving the membrane. It is ready to use and remains flexible during freeze-thaw cycles.

Actual coverage rate will vary depending on depth and width of cracks and voids filled.

All surfaces should be free from oil, grease, rust, dirt and any other debris. Apply directly to any surface flaw with a trowel or putty knife.

CWMA-12105
5 Gallon Bucket
Each or 36/Pallet



EcoFlash

EcoFlash Transition Strips are designed to be used as a surface transition strip with Air Barrier Assemblies and can also be used for flashing.

EcoFlash transition strips are self-adhering smooth surfaced modified bitumen membranes. The strips should be located at beams, columns, changes in substrate material, and similar joints or connections to provide continuity of the air/vapor barrier assembly.

The strips come in 75' lengths and are available in 4", 6", 12", 18" and 24" widths.

1800 or 1200 VP are spray applied coatings providing a 100% bond to the substrate by manufacturer accredited applicators. 1200 Primer is the primer for the transition strip. 1800 is self priming. 1800 or 1200 Mastics are used to fill any cracks or voids in the masonry that will be receiving the system.

EcoFlash Transition Strip is a self-adhering, cold applied composite sheet membrane comprised of 36 mils of rubberized asphalt integrally bonded to a 4 mil film of high density cross-laminated polyethylene for a minimum thickness of 40 mils.

4"	9/box	475 EcoFlash	CETS-0475
6"	6/box	675 EcoFlash	CETS-0675
12"	3/box	1275 EcoFlash	CETS-1275
18"	2/box	1875 EcoFlash	CETS-1875
24"	1/box	2475 EcoFlash	CETS-2475



Questions?
Call Mar-flex Today!

800 498 1411

Mar-flex ProVention 363™

Mar-flex ProVention 363 Solvent or Water Based

Mar-flex ProVention 363 Waterproofing is a tested and proven membrane for commercial applications. Its permanent elasticity allows it to move with the structure. Mar-flex ProVention 363 will not become brittle, evaporate, lose its flexibility or its waterproofing ability. It resists freeze-thaw cycles. It is available in solvent-based or water-based.

Uses

Mar-flex ProVention 363 is ideal for vertical commercial wall applications. In addition, it can be used in horizontal applications such as parking garages, bridge decks, and plaza decking.

An industry-leading warranty

Use the chart below to select the system – and warranty – that best meets your poured wall waterproofing needs. Complete warranty and details available upon request.

LEVEL	MEMBRANE	BOARD gives you	WARRANTY
Horizontal	ProVention 363	"C" Drain 400	Up to 5 Years
Vertical	ProVention 363	"C" Drain 150 Geo-Mat Plus Shockwave	Up to 10 Years

Call Mar-flex for warranty details on commercial applications. 800 - 498 - 1411



BGC-36312
Water-based
5 Gallon
Each or 36/Pallet



BGC-36314
Water-based
55 Gallon
Each or 4/Pallet



BGC-36315
Solvent-based
55 Gallon
Each or 4/Pallet

10 FT. Vertical Application

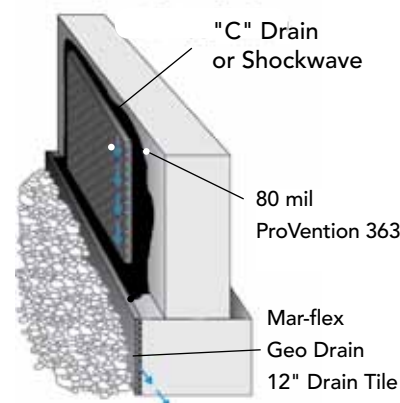
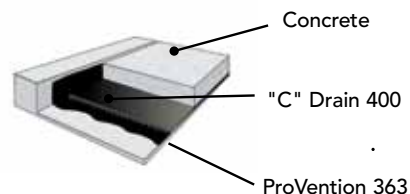

Illustration shown in typical 10 ft. lift
Gravel required at each 10' lift.

*Taller wall levels require additional mil thickness.

Specifications utilizing the Construction Specifications Institute (CSI) Manual of Practice, including MasterFormat™, SectionFormat™ and PageFormat™ are available. It is a manufacturing specific proprietary product specification using the proprietary method of specifying applicable to project specifications and master guide specifications.

Horizontal Application



Properties Mar-flex ProVention 363			
Total Solids	75-80% SB, 70-80% WB	Total Cure Time	24 hrs.
Application Method	Spray, brush or roller	Tensile Strength	56.4 psi min. SB, 48 psi min. WB
Elongation @ 70° F	1750% min. SB, 1800% WB	Coverage Rate	20 sq. ft./gal
Application Range	0°-150° F SB, 20°-130° F WB	Vertical	80 mil dry thickness
Weight/Gallon	7.8 lbs. SB, 7.6 lbs. WB	Horizontal	100 mil dry thickness

Moisture Block 361™



Moisture Block 361™ Water Based

Moisture Block 361™ Water Based is a patented, asphalt emulsion coating designed to dampproof and protect concrete and concrete masonry surfaces. It is a single component liquid applied coating with good resistance to temperature changes and is flexible at low temperatures. It also has excellent weatherability and resists water penetration.

The durable film bonds to most clean, dry and firm surfaces. All surfaces to be coated must be clean, dry, sound; free from oil, grease, rust, scale, loose paint and dirt. Moisture Block 361™ is compatible with Mar-flex Drainage and Insulation Boards.

Moisture Block 361 complies with ASTM D 1227-95, Type 2, Class 1 and ASTM D 1187, Type 1.

Uses

Mar-flex Moisture Block 361™ is recommended for below grade dampproofing of precast concrete, poured concrete and concrete masonry surfaces as well as a vapor barrier on the exterior face of the interior wall of above-grade exterior cavity walls. It also excels as a utility coating on wooden posts, pilings and other metal surfaces set into the ground.

Application

Application will depend on condition and porosity of surface to be coated. Dampproofing applications should be made at a rate of approximately 50 sq. ft./ gal. This product should be applied as received. Keep container covered when not in use. Material should be spray applied with Mar-flex Spray Unit or similar suitable air-less spray equipment. Application may also be accomplished manually with a brush. See installation instructions for complete details.

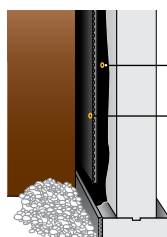

Moisture Block 361
Optional Board
Below-Grade Application

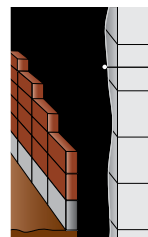

Moisture Block 361
Above-Grade Application



Properties Moisture Block 361™ Water-based

Total Solids	55-60%	Tensile Strength	32 psi min.
Application Method	Spray, brush or roller	Weight/Gallon	7.6 lbs.
Elongation @ 70° F	180% min.	Coverage Rate	50 sq. ft./gal.
Application Range	20° to 130° F	Spray & Board	20 mil dry thickness
Total Cure Time	24 hrs.	Spray Only App.	20 mil dry thickness

ShockWave™ Drainage Board



Shockwave is the newest innovation in waterproofing. Designed as a superior drainage board with unsurpassed features that address the needs of applicators, builders and homeowners.

Shockwave is made of environmentally green closed-cell, cross-linked foam. Shockwave protects the wall and membrane during the backfill process with its CRM (crush resistant memory) which allows it to bounce back to its original configuration when compressed. Shockwave effectively channels water away from foundation walls. It also can be used on horizontal surfaces such as planter boxes and green roof systems.



Product Specifications:	Size/Pc.	Pcs./Pallet	Sq. Ft./Pallet	Drainage
1" Shockwave	1" x 3' x 4'	40	480	50/gal/hr/lin. ft.
2" Shockwave	2" x 3' x 4'	20	240	101/gal/hr/lin. ft.

1" Shockwave

1" Shockwave has 40 pieces per pallet that are 3' x 4'. Each pallet contains 480 square feet.

Sold by the pallet,

68 pallets/truckload.



DM-48325

2" Shockwave

2" Shockwave has 20 pieces per pallet that are 3' x 4'. Each pallet contains 240 square feet.

Sold by the pallet,

68 pallets/truckload.



DM-48350

Drainage Board/Drainage Tile/Insulation Protection Board

Geo-mat "C" Drain

Geo-mat "C" Drain is a high performance, high strength drainage composite mat consisting of a high-impact polystyrene core and a high-strength non-woven filter fabric. The filter acts as a barrier to prevent the passage of soil particles into the core while still allowing moisture to pass freely. Geo-mat "C" Drain is designed for use in high-flow, high-compression strength, vertical and horizontal drainage applications where single-sided subsurface and high density drainage core (400) drainage is needed.

The "PF" (Protective Film) version is available in the 150 series and adds a high-strength polymeric film adhered to the flat side of the drainage core and provides additional safety from potential die cutting into the waterproofing membrane.

Available in the following compression strengths (psf) for a variety of applications.

Roll Size: 4' x 50', 200 sq. ft./roll
Each or 6/Pallet



Geo-mat "C" Drain45	Part# DP-48300	4,500 psf
Geo-mat "C" Drain110	Part# DP-48325	11,000 psf
Geo-mat "C" Drain150	Part# DP-48350	15,000 psf
Geo-mat "C" Drain150PF	Part# DP-48355	15,000 psf
Geo-mat "C" Drain 400	Part# DP-48375	40,000 psf

Mar-flex Geo Drain Tile 12"

Mar-flex Geo Drain Tile 12" is a three dimensional, high-flow, drainage core that is wrapped with a non-woven filter fabric. It is designed to replace conventional gravel covered pipe drainage around foundation and retaining walls.

Each or 8/pallet
Roll Size: 12" x 165' Thickness: 1"



DAP-52300



Mar-flex Neo-Foam

Mar-flex "Neo-Foam" Insulation Board with *Neopor™ technology is a ASTM-C 518-04 expandable polystyrene foam board that has considerably better thermal insulation capacity than conventional EPS products. The insulating panels made of *Neopor™ are the solution for architects, contractors and builders alike. The high-tech *Neopor™ foam sets new standard for insulating efficiency and environmental compatibility all while using far less product to achieve the same insulating effect.

(Sold in full truckload quantities only)

*BASF Trademark



NF-11255

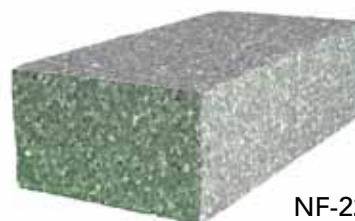

NF-22510

Product	R-Value	Packaging Information
(NF-11255) 1.188 Neo-foam Size/Pc 1.188" x 48"x48"	R-5	80 Sheets / Pallet 1280 sq ft / Pallet 24 Pallet Full Truckload
(NF-22510) 2.375 Neo-foam Size/Pc 2.375"x48"x48"	R-10	40 Sheets / Pallet 640 sq ft / Pallet 24 Pallet Full Truckload

*If flat bed, 22 Pallets Full Truckload. Also available in 48"x 96" Sheets

Geo Drain/Accessories

12" End Out Connector

A 12" end out connector is used to make the connection from Mar-flex Geo Drain 12" to a corrugated 4" plastic pipe.

10/box



DAP-52305

12" Side Out Connector

A 12" side out connector is used to make an in line connection of the Mar-flex Geo Drain 12" with a 4" outlet.

10/box



DAP-52310

12" Corner Connector

A 12" corner connector is used to connect two sections of Mar-flex Geo Drain 12" on either an inside or outside corner.

10/box



DAP-52320

12" Splice Connector

A 12" splice connector is used to connect two sections of the Mar-flex Geo Drain 12" either vertically or horizontally.

10/box



DAP-52325

Mastic/Concrete Sealer

Board Fasteners

Drainage board fasteners. Fastens board to poured wall, providing an additional bond until backfilled. May be installed into concrete with hammer.

- | | | |
|--------|--------------------|-----------------------|
| 1" | 500/box – AI-28132 | • DrainAway |
| 1-1/4" | 500/box – AI-28134 | • 3/4" Drain & Dry |
| 1-1/2" | 500/box – AI-28136 | • 1-3/16" Drain & Dry |
| | | • 1" Shockwave |
| 2-1/2" | 500/box – AI-28138 | • 2-3/8" Drain & Dry |
| | | • 2" Shockwave |

AI-28132



AI-28134

AI-28136



AI-28138

362 All Season Mastic

All Season Mastic is a heavy bodied trowel grade coating. It is excellent for patching tie holes and filling in honeycombed areas in both rough and smooth masonry surfaces.

- Remains flexible during freeze-thaw cycles
- Can be used during any season
- Ready to use
- Color – Black
- Consistency – Rubber coating
- ASTM D-4586 Type I
- ASTM D-3409



BGM-36205

5 Gallon Bucket
Each or 42/Pallet

SurfiSeal Concrete & Brick Sealer™

SurfiSeal Concrete and Brick Sealer is a water-based emulsion of siloxane that penetrates into concrete or masonry to provide long term weatherproofing protection. Product is ready to use; the invisible film that forms will "bead" water and protect the substrate many times longer than conventional coatings. Provides protection against deicing salts and chloride ions and will not change traction or skid resistance of a surface.



CWSS-0005

5 Gallon Bucket
Each or 36/Pallet

The Mar-flex 3 Step System

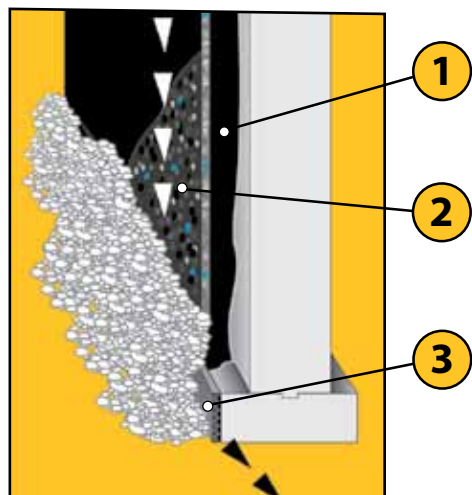

Water transported away from basement.

Waterproofing: The Mar-flex 3-Step System

Mar-flex developed its 3-step system to protect the poured foundation wall of a home and eliminate the devastating effects of water – including mold and mildew. The result? Decades of dry, worry-free lower level living.

- 1 Waterproofing membrane seals wall**
First, a highly-impermeable membrane is applied to the exterior concrete walls. This specially formulated spray coating is the first line of defense in sealing water out of the basement.
- 2 Drainage board protects and insulates wall**
After the membrane is applied, a high-quality drainage board is installed to protect the coating, while helping channel water away from the home's foundation.
- 3 Drainage tile transports water away from foundation**
Finally, drainage tile is installed along the footer/foundation walls to channel water into the sump/drainage system and transport water away from the basement.

1



Mar-Flex 5000™



QuickSeal™



2



ShockWave™

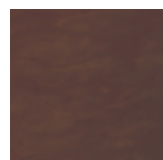

Drain & Dry Board
with Ecosse Technology



Geo-Mat PLUS

3



Mar-flex Geo Drain Tiles

Mar-flex 5000™ Water Based



Flexible Seamless Coating that seals out moisture

Mar-flex 5000™ Water Based

Years in development, this heavy-duty, elastomeric emulsion membrane can be applied to any wall foundation. Its special formulation sprays easily and predictably, producing a viscous, flexible, seamless seal that resists freeze-thaw cycles. The result? Homeowners no longer have to put up with wet basements.

An industry-leading warranty

Use the chart below to select the system – and warranty – that best meets your poured wall waterproofing needs. Complete warranty and details available upon request.

Code Compliance

ICC Evaluation Service, Inc. (ICC-ES) has issued evaluation report ESR-3062 on the Mar-flex 5000™, Fusion™ and QuickSeal™ Waterproofing Membranes. ICC-ES finds that, subject to the conditions set forth in ESR-3062, the membranes comply with the 2006 International Building Code (IBC) and the 2006 International Residential Code (IRC), or are suitable alternatives to what is specified in the codes.

LEVEL	MEMBRANE	combined with	BOARD	gives you	WARRANTY
Standard	Mar-flex 5000		None		15 Years
Bronze	Mar-flex 5000		Geo-Mat Plus 3/4" Drain & Dry		40 Years
Silver	Mar-flex 5000		1" Shockwave 1-3/16" Drain & Dry		50 Years
Gold	Mar-flex 5000		2" Shockwave 2-3/8" Drain & Dry		60 Years



BGW-36152
5 Gallon Bucket
Each or 36/Pallet



BGW-36154
55 Gallon Drum
Each or 4/Pallet



BGW-36153
330 Gallon Tote



BGW-36159
6,000 Gallon Bulk

Properties Mar-flex 5000 Water-based

Total Solids	60-70%	Tensile Strength	48 psi min.
Application Method	Spray, brush or roller	Weight/Gallon	7.5 lbs.
Elongation @ 70° F	1725% min.	Coverage Rate	20 sq. ft./gal.
Application Range	20° to 130° F	Spray & Board	60 mil dry thickness
Total Cure Time	24 hrs.	Spray Only App.	40 mil dry thickness
Hydrostatic Head Pressure: Resistance to hydrostatic pressure of 15 psig (103 kPa) over a 1/8" wide crack.			

Mar-flex 5000™ Solvent Based

Mar-flex 5000™ Solvent Based

Years in development, this heavy-duty, elastomeric membrane can be applied to any wall foundation. Its special formulation sprays easily and predictably, producing a viscous, flexible, seamless seal that resists freeze-thaw cycles. The result? Homeowners no longer have to put up with wet basements.

An industry-leading warranty

Use the chart below to select the system – and warranty – that best meets your poured wall waterproofing needs. Complete warranty and details available upon request.

LEVEL	MEMBRANE	combined with	BOARD	gives you	WARRANTY
Standard	Mar-flex 5000		None		15 Years
Bronze	Mar-flex 5000		Geo-Mat Plus 3/4" Drain & Dry		40 Years
Silver	Mar-flex 5000		1" Shockwave 1-3/16" Drain & Dry		50 Years
Gold	Mar-flex 5000		2" Shockwave 2-3/8" Drain & Dry		60 Years



BGW-36155
55 Gallon Drum
Each or 4/Pallet



BGW-36158
6,000 Gallon Bulk



Code Compliance

ICC Evaluation Service, Inc. (ICC-ES) has issued evaluation report ESR-3062 on the Mar-flex 5000™, Fusion™ and QuickSeal™ Waterproofing Membranes. ICC-ES finds that, subject to the conditions set forth in ESR-3062, the membranes comply with the 2006 International Building Code (IBC) and the 2006 International Residential Code (IRC), or are suitable alternatives to what is specified in the codes.

Properties Mar-flex 5000 Solvent-based

Total Solids	70-75%	Tensile Strength	48 psi min.
Application Method	Spray, brush or roller	Weight/Gallon	7.6 lbs.
Elongation @ 70° F	1725% min.	Coverage Rate	20 sq. ft./gal.
Application Range	0° to 150° F	Spray & Board	60 mil dry thickness
Total Cure Time	24 hrs.	Spray Only App.	40 mil dry thickness
Hydrostatic Head Pressure: Resistance to hydrostatic pressure of 15 psig (103 kPa) over a 1/8" wide crack.			

Mar-flex QuickSeal™ Water Based



Flexible Seamless Coating seals out moisture

Code Compliance

ICC Evaluation Service, Inc. (ICC-ES) has issued evaluation report ESR-3062 on the Mar-flex 5000™, Fusion™ and QuickSeal™ Waterproofing Membranes. ICC-ES finds that, subject to the conditions set forth in ESR-3062, the membranes comply with the 2006 International Building Code (IBC) and the 2006 International Residential Code (IRC), or are suitable alternatives to what is specified in the codes.

QuickSeal™ Water Based

An affordable upgrade from entry level waterproofing, QuickSeal™ is a modified polymer emulsion membrane that can be applied to any foundation wall. Its special formulation produces a seal that prevents water from seeping through the walls.

An industry-leading warranty

Use the chart below to select the system – and warranty – that best meets your poured wall waterproofing needs. Complete warranty and details available upon request.

LEVEL	MEMBRANE	combined with BOARD	gives you WARRANTY
Economy	QuickSeal	None	10 Years
Premium	QuickSeal	Geo-Mat Plus Shockwave Drain & Dry	20 Years

QuickSeal's special formulation produces a seal that prevents water from seeping through the walls.



BGW-36134
55 Gallon Drum
Each or 4/Pallet



BGW-36133
330 Gallon Tote



BGW-36139
6,000 Gallon Bulk

Properties Mar-flex QuickSeal Water-based

Total Solids	60 -70%	Tensile Strength	32 psi min.
Application Method	Spray, brush or roller	Weight/Gallon	7.5 lbs.
Elongation @ 70° F	850% min.	Coverage Rate	25-30 sq. ft./gal.
Application Range	20° to 130° F	Spray & Board	60 mil dry thickness
Total Cure Time	24 hrs.	Spray Only App.	40 mil dry thickness
Hydrostatic Head Pressure: Resistance to hydrostatic pressure of 5 psig (34 kPa) over a 1/8" wide crack.			

Mar-flex QuickSeal™ Solvent Based

QuickSeal™ Solvent Based

An affordable upgrade from entry level waterproofing, QuickSeal™ is a modified polymer membrane that can be applied to any foundation wall. Its special formulation produces a seal that prevents water from seeping through the walls.

An industry-leading warranty

Use the chart below to select the system – and warranty – that best meets your poured wall waterproofing needs. Complete warranty and details available upon request.

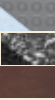
LEVEL	MEMBRANE	combined with	BOARD	WARRANTY
Economy	QuickSeal		None	10 Years
Premium	QuickSeal		Geo-Mat Plus Shockwave Drain & Dry	20 Years



BGW-36135
55 Gallon Drum
Each or 4/Pallet



BGW-36138
6,000 Gallon Bulk



Code Compliance

ICC Evaluation Service, Inc. (ICC-ES) has issued evaluation report ESR-3062 on the Mar-flex 5000™, Fusion™ and QuickSeal™ Waterproofing Membranes. ICC-ES finds that, subject to the conditions set forth in ESR-3062, the membranes comply with the 2006 International Building Code (IBC) and the 2006 International Residential Code (IRC), or are suitable alternatives to what is specified in the codes.

Properties Quick Seal Solvent-based

Total Solids	70-75%	Tensile Strength	32 psi min.
Application Method	Spray, brush or roller	Weight/Gallon	7.5 lbs.
Elongation @ 70° F	850% min.	Coverage Rate	35 sq. ft./gal.
Application Range	0° to 150° F	Spray & Board	60 mil dry thickness
Total Cure Time	24 hrs.	Spray Only App.	40 mil dry thickness
Hydrostatic Head Pressure: Resistance to hydrostatic pressure of 5 psig (34 kPa) over a 1/8" wide crack.			

FUSION UV™ Water Based



Fusion UV™ Water Based

Fusion UV™ is a 100% virgin polymer waterproofing membrane that can be applied to any foundation wall. Its formulation sprays easily, producing a flexible, seamless seal that resists freeze-thaw cycles. Fusion UV™ is available in UV resistant gray.

An industry-leading warranty

Use the chart below to select the system – and warranty – that best meets your poured wall waterproofing needs. Complete warranty and details available upon request.

Code Compliance

ICC Evaluation Service, Inc. (ICC-ES) has issued evaluation report ESR-3062 on the Mar-flex 5000™, Fusion™ and QuickSeal™ Waterproofing Membranes. ICC-ES finds that, subject to the conditions set forth in ESR-3062, the membranes comply with the 2006 International Building Code (IBC) and the 2006 International Residential Code (IRC), or are suitable alternatives to what is specified in the codes.

LEVEL	MEMBRANE	combined with	BOARD	gives you	WARRANTY
Standard	Fusion UV		None		15 Years
Premium	Fusion UV		Geo-Mat Plus Shockwave Drain & Dry		Limited Lifetime

FUSION UV is a 100% virgin polymer waterproofing membrane that can be applied to any poured foundation wall.



RWW-02-05
5 Gallon Bucket
Each or 36/Pallet



RWW-02-55
55 Gallon Drum
Each or 4/Pallet

Properties Mar-flex FUSION UV Water-based

Total Solids	59%	Tensile Strength	350 psi min.
Application Method	Spray, brush or roller	Weight/Gallon	11 lbs.
Elongation @ 70° F	1800% min.	Coverage Rate	40 sq. ft./gal.
Application Range	20° to 130° F	Spray & Board	60 mil dry thickness
Total Cure Time	24 hrs.	Spray Only App.	40 mil dry thickness
Hydrostatic Head Pressure: Resistance to hydrostatic pressure of 5 psig (34 kPa) over a 1/8" wide crack.			

LiteFUSION™



LiteFUSION Water Based

Mar-flex LiteFUSION is an economical water-based acrylic waterproofing membrane for use when hydrostatic pressure exists. It has the ability to bridge cracks that might later develop in a foundation, and can protect from the dangers of moisture, which can cause mold and mildew.

Mar-flex LiteFUSION is specifically designed for waterproofing pre-cast, poured and masonry foundation walls. Mar-flex Lite FUSION is a spray-on membrane, so it dries as a seamless, monolithic coating. It has no odor and will dry to a gray color to blend with the color of concrete. LiteFUSION is compatible with Mar-flex drainage and insulation boards.

Unlike dampproofing, a waterproofing membrane is designed to stop water infiltration and be extremely effective when applied on the exterior of a foundation system.



Code Compliance

ICC Evaluation Service, Inc. (ICC-ES) has issued evaluation report ESR-3062 on the Mar-flex 5000™, Fusion™ and QuickSeal™ Waterproofing Membranes. ICC-ES finds that, subject to the conditions set forth in ESR-3062, the membranes comply with the 2006 International Building Code (IBC) and the 2006 International Residential Code (IRC), or are suitable alternatives to what is specified in the codes.



RWW-01-5
5 Gallon Bucket
Each or 36/Pallet



RWW-01-55
55 Gallon Drum
Each or 4/Pallet

LiteFUSION is specifically designed for waterproofing pre-cast, poured and masonry foundation walls. It is a spray-on membrane, so it dries as a seamless, monolithic coating.

Properties Mar-flex LiteFUSION Water-based

Total Solids	50-55%	Tensile Strength	170 psi min.
Application Method	Spray, brush or roller	Weight/Gallon	10 lbs.
Elongation @ 70° F	300% min.	Coverage Rate	50 sq. ft./gal.
Application Range	40° to 100° F	Spray & Board	20 mil dry thickness
Total Cure Time	24 hrs.	Spray Only App.	17 mil dry thickness

Residential

Foundation Dampproofing

DampFUSION™



DampFUSION is a spray-on membrane, so it dries as a seamless, monolithic coating. It can be applied to pre-existing damp walls and to the top of the foundation wall.



Mar-flex DampFUSION Water Based

Mar-flex DampFUSION is an excellent water-based acrylic dampproofing membrane approved for masonry, block, pre-cast and poured concrete wall foundations. It will stop water vapor and protect against leaks.

Mar-flex DampFUSION is a spray-on membrane, so it dries as a seamless, monolithic coating. It can be applied to pre-existing damp walls and the top of the foundation wall. It has no odor and will dry to a gray color to blend with the color of concrete. DampFUSION is compatible with Mar-flex drainage and insulation boards.

Dampproofing is often confused with waterproofing. Dampproofing simply slows down water penetration but does not completely waterproof a foundation. It is generally very effective in stopping water vapor transmission.

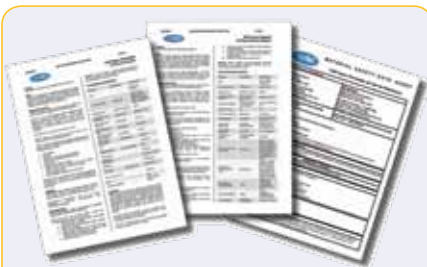

For 3-Part Specifications, Spec Data, & MSDS sheets, visit our website at www.mar-flex.com or call 800.498.1411



RWD-01-5
5 Gallon Bucket
Each or 36/Pallet



RWD-01-55
55 Gallon Drum
Each or 4/Pallet

Properties Mar-flex DampFUSION Water-based

Total Solids	35-42%	Tensile Strength	150 psi min.
Application Method	Spray, brush or roller	Weight/Gallon	9 lbs.
Elongation @ 70° F	180%	Coverage Rate	115-125 sq. ft./gal.
Application Range	40° to 100° F	Spray & Board	10 mil dry thickness
Total Cure Time	24 hrs.	Spray Only App.	10 mil dry thickness

Dampproofing Water-Based



Below-grade
spray only application

Application

Application will depend on condition and porosity of surface to be coated. Dampproofing applications should be made at a rate of approximately 2 gallons/100 ft.². This product should be applied as received. Keep container covered when not in use. Material should be spray applied with Mar-flex Spray Unit or similar suitable air-less spray equipment. Application may also be accomplished manually with a brush or roller. See installation instructions for complete details.

Code Compliance

Mar-flex Dampproofing complies with ASTM D 1227-95, Type 2, Class 1 and ASTM D 1187, Type 1.

Mar-flex Dampproofing Water Based is a heavy-bodied cut-back asphalt emulsion protective coating used when dampproofing is required. It forms a smooth, tough, almost rubber-like film when dry. Mar-flex Dampproofing has moderately good resistance to temperature changes, is flexible at low temperatures, has excellent weatherability and resists water penetration.

The durable film bonds to most clean, dry and firm surfaces. All surfaces to be coated must be clean, dry, sound; free from oil, grease, rust, scale, loose paint and dirt. Mar-flex Dampproofing is compatible with Mar-flex Drainage and Insulation Boards.

Uses

Mar-flex Dampproofing is recommended for dampproofing below-grade, vertical basement walls of poured concrete or unit masonry construction. It serves as a vapor barrier on the exterior face of the interior walls of above-grade exterior masonry cavity walls. It also excels as a utility coating on posts, pilings and other metal surfaces set into the ground.

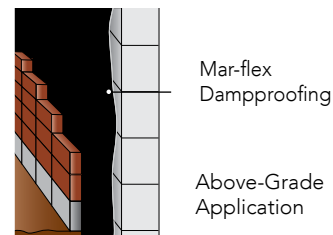
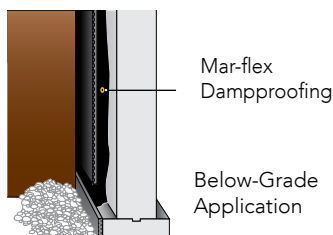

BGD-36120
5 Gallon Bucket
Each or 36/Pallet



BGD-36125
55 Gallon Drum
Each or 4/Pallet



BGD-36123
330 Gallon Tote



BGD-36129
6,000 Gallon Bulk



Properties Mar-flex Dampproofing Water-based

Total Solids	45-60%	Tensile Strength	32 psi min.
Application Method	Spray, brush or roller	Weight/Gallon	6.8 lbs.
Elongation @ 70° F	180% min.	Coverage Rate	50 sq. ft./gal.
Application Range	20° to 130° F	Spray & Board	20 mil dry thickness
Total Cure Time	24 hrs.	Spray Only App.	20 mil dry thickness

Dampproofing & Foundation Coating Solvent-Based

Dampproofing Solvent Based

Mar-flex Dampproofing is a heavy-bodied cutback asphalt protective coating used when dampproofing is required. It forms a smooth, tough, almost rubber-like film when dry. Mar-flex Dampproofing has moderately good resistance to temperature changes, is flexible at low temperatures, has excellent weatherability and resists water penetration. The durable film bonds to most clean, dry and firm surfaces. All surfaces to be coated must be clean, dry, sound; free from oil, grease, rust, scale, loose paint and dirt. Mar-flex Dampproofing & Foundation Coating is compatible with Mar-flex Drainage and Insulation Boards.

Uses

Mar-flex Dampproofing is recommended for dampproofing below-grade, vertical basement walls of poured concrete or unit masonry construction. It serves as a vapor barrier on the exterior face of the interior walls of above-grade exterior masonry cavity walls. It also excels as a utility coating on posts, pilings and other metal surfaces set into the ground.

Application

Application will depend on condition and porosity of surface to be coated. Dampproofing applications should be made at a rate of approximately 2 gallons per 100 ft². This product should be applied as received. Keep container covered when not in use. Material should be spray applied with Mar-flex Spray Unit or similar suitable air-less spray equipment. Application may also be accomplished manually with a brush or roller. See installation instructions for complete details.



Code Compliance

Mar-flex Dampproofing complies with ASTM D 1227-95, Type 2, Class 1 and ASTM D 1187, Type 1.



BGD-36115
55 Gallon Drum
Each or 4/Pallet



BGD-36118
6,000 Gallon Bulk

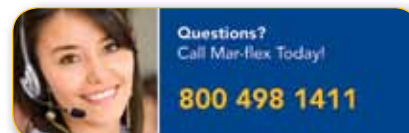

Properties Dampproofing Solvent-based

Total Solids	63%	Tensile Strength	32 psi min.
Application Method	Spray, brush or roller	Weight/Gallon	7.6 lbs.
Elongation @ 70° F	180% min.	Coverage Rate	50 sq. ft./gal.
Application Range	0° to 150° F	Spray & Board	20 mil dry thickness
Total Cure Time	24 hrs.	Spray Only App.	20 mil dry thickness

ShockWave™ Drainage Board



Shockwave is the newest innovation in waterproofing. Designed as a superior drainage board with unsurpassed features that address the needs of applicators, builders and homeowners.

Shockwave is made of environmentally green closed-cell, cross-linked foam. Shockwave protects the wall and membrane during the backfill process with its CRM (crush resistant memory) which allows it to bounce back to its original configuration when compressed. Shockwave effectively channels water away from the foundation walls.



Product Specifications:	Size/Pc.	Pcs./Pallet	Ft. ² /Pallet	Drainage
1" Shockwave	1" x 3' x 4'	40	480	50/gal/hr/lin. ft.
2" Shockwave	2" x 3' x 4'	20	240	101/gal/hr/lin. ft.

1" Shockwave

1" Shockwave has 40 pieces per pallet that are 3' x 4'. Each pallet contains 480 square feet.

Sold by the pallet,

68 pallets/truckload.



DM-48325

2" Shockwave

2" Shockwave has 20 pieces per pallet that are 3' x 4'. Each pallet contains 240 square feet.

Sold by the pallet,

68 pallets/truckload.



DM-48350

Residential

Drainage & Insulation Board & Roll

Drain & Dry Board with Ecosse Technology

Ecosse Drain & Dry Boards

Ecosse Drain & Dry Boards are made with Ecosse Technology that converts bio-based materials into an inert polymer that bonds mineral wool strands together, eliminating the formaldehyde and phenols found in traditional binders and insulations. The Drain & Dry Board comes in several sizes. These boards offer protection for the waterproofing or dampproofing membrane during backfilling operations, good drainage properties and thermal insulation.

Ecosse Drain & Dry boards are compatible with any of the Mar-flex waterproofing or dampproofing membranes.

Ecosse Drain & Dry boards should be installed from the top of the footing to the grade line and are applied shortly after membrane application and before backfilling operations start.



Product Specifications:	Size/Bundle	Pcs./Bundle	Ft. ² /Bundle	R-Values	Drainage
3/4" Drain & Dry Board	3/4" x 3' x 4'	18	216	3.1	Up to 65 gal/hr/lin. ft.
1-3/16" Drain & Dry Board	1-3/16" x 3' x 4'	12	144	5.0	Up to 125 gal/hr/lin. ft.
2-3/8" Drain & Dry Board	2-3/8" x 3' x 4'	6	72	10.0	Up to 190 gal/hr/lin. ft.

3/4" Drain & Dry Board™

3/4" Drain & Dry Board has 18 pieces per bundle that are 3' x 4' with an R-Value of 3.1. Each bundle contains 216 square feet. Sold by the bundle, 232 bundles per truck load.

3/4"



DM-48200

1-3/16" Drain & Dry Board™

1-3/16" Drain & Dry Board has 12 pieces per bundle that are 3' x 4' with an R-Value of 5.0. Each bundle contains 144 square feet. Sold by the bundle, 232 bundles per truck load.

1 3/16"



DM-48225

2-3/8" Drain & Dry Board™

2-3/8" Drain & Dry Board has 6 pieces per bundle that are 3' x 4' with an R-Value of 10.0. Each bundle contains 72 square feet. Sold by the bundle, 232 bundles per truck load.

2 3/8"



DM-48250

GEO-MAT™ Products

Mar-flex GEO-MAT™

Mar-flex Geo-Mat rolls are made of high density polyethylene (HDPE) which offers strong resistance to hydrostatic pressure and excellent drainage.

Mar-flex Geo-Mat rolls feature dimples that are aligned along vertical and horizontal axis to rapidly channel water from grade to the footer drainage system.

Geo-Mat or Geo-Mat Plus can be used as a foundation dampproofing as well as a sheet waterproofing material in certain instances. In areas where there is low hydrostatic pressure, for example when a drainage system is installed, the Geo-Mat products can be considered for use as a waterproofing membrane. Standard Geo-Mat is also available in a high compression (HC) version as well.

Geo-Mat is considered a GREEN product and can be used toward LEEDS building credits.

Mar-flex Geo-Mat accessories are available to professionally complete any job.

Material	Color	Roll Height	Roll Length	Compression Resistance	Drainage Capacity	Rolls/Pallet
Geo-Mat	Gray	6'9" & 8'	50'	4177 psf.	30.1 gal/min/ft ²	12 Rolls
Geo-Mat Plus	Gray-White	4' & 8'	50'	7590 psf.	30.1 gal/min/ft ²	9 Rolls
Geo-Mat HC	Gray	4', 6.9', & 8'	50'	7590 psf.	30.1 gal/min/ft ²	12 Rolls

Mar-flex GEO-MAT™

Mar-flex Geo-Mat is a high density polyethylene drainage roll used for dampproofing. Stud shaped dimples provide an air chamber between roll and wall which keeps wall dry. Mar-flex Geo-Mat is resistant to saline solutions, alkalis and acids.

Roll Size: 6'9" & 8' x 50' 337.5/400 sq. ft./roll Each or 12/Pallet



GM-48260 – 8'x50'
GM-48255 – 6.9'x50'

**Mar-flex GEO-MAT™ Plus**

Mar-flex Geo-Mat Plus is a high density polyethylene (HDPE) roll with an attached polypropylene geotextile mat. Mar-flex Geo-Mat Plus is placed polyethylene side against the waterproofing membrane allowing the filter mat to protect against back fill, soil sediment and obstructions.

Mar-flex Geo-Mat Plus is a protection and drainage roll used in conjunction with Mar-flex's waterproofing membranes to form one of Mar-flex's Waterproofing Systems.

Roll Size: 4' & 8' x 50' 200/400 sq. ft./roll Each or 9/Pallet



GM-48270 – 8'x50'
GM-48274 – 4'x50'

**Mar-flex GEO-MAT™ HC (High Compression)**

Mar-flex Geo-Mat High Compression (HC) is like our regular Mar-flex Geo-Mat but has been re-engineered with high compression properties. Our Mar-flex Geo-Mat HC will meet even the most demanding job requirements where even higher compression resistance properties are specified.

Roll Size: 4, 6'9" & 8' x 50' 200/337.5/400 sq. ft./roll Each or 12/Pallet



GMHC-48208 – 8'x50'
GMHC-48269 – 6.9'x50'
GMHC-49204 – 4'x50'



Waterproofing
and Building
Products

Residential

Drainage & Insulation Board & Roll

GEO-MAT™ Products

Geo Clip

Geo Clip is designed to be used in conjunction with Mar-flex Geo-Mat and Geo-Mat Plus to speed installation. The Geo Clip's prongs help distribute weight to secure board after nail is inserted into preformed center nail hole.

500/box



GM-48277

Profiles

Profiles are designed to be used in conjunction with Mar-flex Geo-Mat & Geo-Mat Plus. The Profile protects the top edge of the polyethylene at grade level from soil penetration between roll and wall. Profile has eight pre-drilled nail holes for ease of installation.

50 (6'6") Profiles/box
325' per box



GM-48280

Adhesive Band

Adhesive Band is designed to be used in conjunction with Mar-flex Geo-Mat during dampproofing applications. The adhesive band seals overlaps and other critical points on flat side of roll.

Roll Size: 6" x 75'
6 rolls/box



GM-48285

Composite Drainage Rolls

Mar-flex Geo-Mat "C" Drain 110

Mar-flex Geo-Mat "C" Drain 110 is a medium-duty dimpled core bonded to a single layer of non-woven filter fabric. Designed as a residential composite drainage system.



DP-48325

Roll Size: 4' x 50'
200 sq. ft./roll
Thickness: .25"



Each or 6/Pallet

Board Fasteners

Drainage board fasteners. Fastens board to poured wall, providing an additional bond until backfilled. May be installed into concrete with hammer.

- | | | |
|--------|--------------------|-----------------------|
| 1" | 500/box – AI-28132 | • DrainAway |
| 1-1/4" | 500/box – AI-28134 | • 3/4" Drain & Dry |
| 1-1/2" | 500/box – AI-28136 | • 1-3/16" Drain & Dry |
| | | • 1" Shockwave |
| 2-1/2" | 500/box – AI-28138 | • 2-3/8" Drain & Dry |
| | | • 2" Shockwave |

AI-28132



AI-28134



AI-28136



AI-28138



Questions?
Call Mar-flex Today!

800 498 1411

Geo Drain 6" Tile/Accessories

Geo Drain 6" Tile

Mar-flex Geo Drain Tile 6" is a three dimensional, high-flow, drainage core that is wrapped with a non-woven filter fabric. It is designed to replace conventional gravel covered pipe drainage around foundation and retaining walls.

Roll Size: 6" x 165' Thickness: 1"

Each or 16/Pallet



DAP-52200



6" Splice Connector

A 6" splice connector is used to connect two sections of the Mar-flex Geo Drain 6" either vertically or horizontally.

10/box



DAP-52220

6" End Cap

A 6" end cap is used to cover the cut end of the Mar-flex Geo Drain 6".

10/box



DAP-52225

6" End Out Connector

A 6" end out connector is used to make the connection from the Mar-flex Geo Drain 6" to a corrugated 4" plastic pipe.

10/box



DAP-52205

6" Side Out Connector

A 6" side out connector is used to make an in line connection of the Mar-flex Geo Drain 6" with a 4" outlet.

10/box



DAP-52210

6" Step-down Connector

A 6" step-down connector is used to connect two sections of Mar-flex Geo Drain 6" on a vertical stepped foundation.

10/box



DAP-52230

6" Corner Connector

A 6" corner connector is used to connect two sections of Mar-flex Geo Drain 6" on either an inside or outside corner.

10/box



DAP-52235

Residential

Mastics/Concrete Sealer

All Season Mastic/Concrete Sealer



362 All Season Mastic

362 All Season Mastic is a heavy bodied trowel grade coating. It is excellent for patching tie holes, filling in honeycombed areas in both rough and smooth masonry surfaces.

- Remains flexible during freeze-thaw cycles
- Can be used during any season
- Ready to use
- Color – Black
- Consistency – Rubber coating
- ASTM D-4586 Type I
- ASTM D-3409

Actual coverage rate will vary depending on the thickness of product applied. All surfaces should be free from oil, grease, rust and any other debris. Can be trowel or hand applied over wall ties, honeycombs or any surface flaw. Remove below grade wall ties inside the basement and out. Patch all outside below grade wall ties with 362 Mastic.

BGM-36205
5 Gallon Bucket
Each or 42/Pallet



SurfiSeal Concrete & Brick Sealer™

SurfiSeal Concrete and Brick Sealer is a water-based emulsion of siloxane that penetrates into concrete or masonry to provide long term weatherproofing protection. Product is ready to use; the invisible film that forms will "bead" water and protect the substrate many times longer than conventional coatings.

Provides protection against deicing salts and chloride ions and will not change traction or skid resistance of a surface.



CWSS-0005
5 Gallon Bucket
Each or 36/Pallet

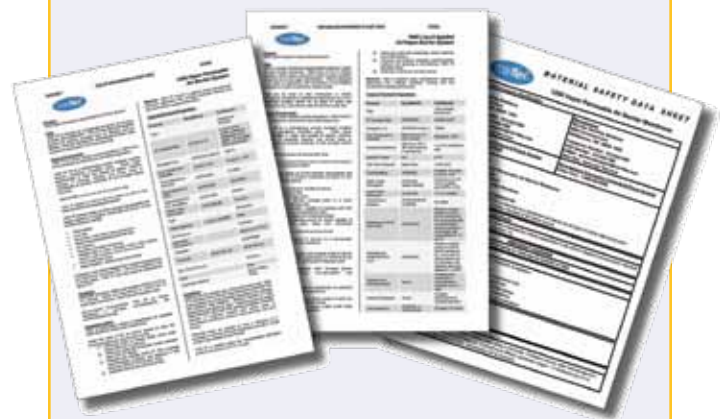

**For 3-Part Specifications,
Spec Data, & MSDS sheets,**
visit our website at www.mar-flex.com
or call **800.498.1411**

RhinoWells Egress Window Wells



RhinoWells Egress Window Wells meet basement building codes for below-grade living space egress and features a built-in stair design.

RhinoWells (Short)

76" Width x 44" Projection x 63" Height
Inside Width at Top 69-1/2"
Inside Width at Bottom 56-1/2" Patent Pending

*Installation hardware kit WW-44180 Sold Separately
*recommended

Each or 6/pallet



Sandstone – WW-44110



Granite-WW-44115

RhinoWells Egress Window Well (Tall)

76" Width x 44" Projection x 83" Height
Inside Width at Top: 69-1/2"
Inside Width at Bottom: 56-1/2" Patent Pending

*Installation hardware kit WW-44180 Sold Separately
*Must be used to validate warranty

Each or 5/pallet



Sandstone – WW-44118



Granite-WW-44119

Accessories

Egress Window Well Cover

Egress clear covers are designed to fit all RhinoWells.

WW-44170



Steel Egress Window Well Grate

Steel Egress Window Well Grate easily secures to the top of the RhinoWells. Primer gray color to blend with well color.

WW-44176



Universal Egress Installation Kit

Hardware needed to install any of the egress window wells. Sold individually.

WW-44180



Waterproofing
and Building
Products

Stonewells Stone Textured Window Wells



Mar-flex Stonewells™ are fitted with a simulated rock texture that looks and feels like real stone at a fraction of the cost. While the built-in-steps provide easy egress in case of a life threatening emergency.

75" Width x 49½" Projection at top x 64½" Height
66" Inside Width, 34" Inside Projection at bottom

- Fine stone texture
- Provides escape with built-in steps
- Meets building codes for below-grade living space egress
- Let in more natural light
- Up to 5' window
- One piece unit, no assembly required
- Dual wall design offers higher backfill rating
- Won't rust or dent like metal
- Enhances your homes value
- Optional Polycarbonate cover eliminates weeds, pests, and rainwater
- Maintenance Free
- Comes in two designer colors to coordinate with Mar-flex RhinoWells™

*Installation hardware kit
WW-44180 Sold Separately

*Must be used to validate warranty

Each or 5/Pallet



Back View

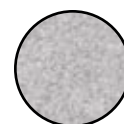

Speckled
Granite



Speckled
Sandstone



WW-44430



WW-44440

Stonewells Cover

Clear window well cover designed to fit Mar-flex Stonewells™ window wells.



WW-44450

ModularWells Modular Egress Window Wells



Modularwells Modular Egress Window Well fits 32" to 48" wide slider or casement windows. The built in steps and ladder offer safe and easy exit from the basement. The lightweight, easy to handle modular design allows you to increase overall well height by adding additional modules in increments of 14". Mounting flanges (pre drilled) attach directly to the foundation. Well is made of polyethylene material with UV inhibitors and is resistant to weather conditions of freezing and thawing. Well is available in an attractive speckled earth tone color.

62" Width x 44" Projection x 21" Height

*Installation hardware kit

WW-44180 Sold Separately

*Must be used to validate warranty

Each or 20/Pallet

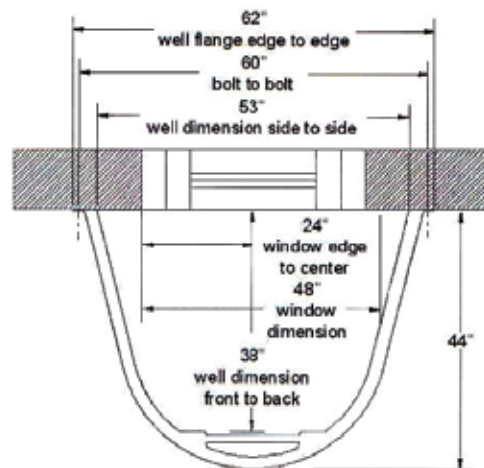

Dimensions



WW-44905

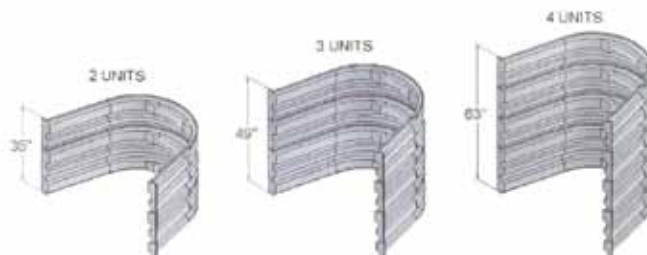

Maximum stack 5 segments

Accessories

Modularwells Well Cover

Window well cover designed to fit Modularwells Modular Egress Window Wells

WW-44925



Landscapes™ No-Maintenance Window Wells



Mar-flex Landscapes™ No-Maintenance Window Wells take lower level living to the next level with features designed to brighten your basement and increase the curb appeal of your home.

- Won't rust or dent like metal
- Feature a built-in floor for maintenance-free construction
- Install easily - no specialty hardware needed
- Includes a drain kit

Landscapes™ well (Small)

46" Width x 17" Projection x 21" Height

Includes drain kit. Standard fasteners may be used for window well installation; no specialty hardware required.
Inside Width at Top: 41"
Inside Width at Bottom: 37"

Each or 25/Pallet

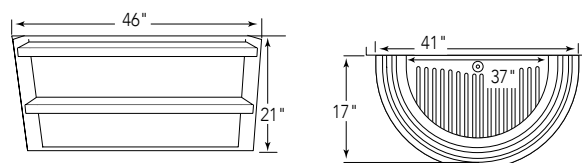

Sandstone – WW-42056

Granite – WW-42058

Landscapes™ well cover (Small)

Clear window well cover designed to fit Landscapes™ Window Well (Small).

Each or 10/box



WW-42140

Landscapes™ well (Large)

52" Width x 19" Projection x 31" Height

Includes drain kit. Standard fasteners may be used for window well installation; no specialty hardware required.

Inside Width at Top: 46-1/2"
Inside Width at Bottom: 39-1/2"

Each or 20/Pallet

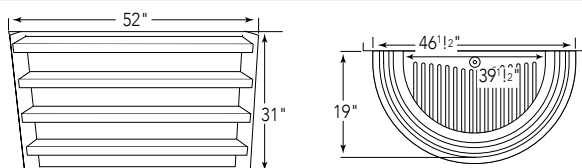

Sandstone – WW-42110

Granite – WW-42115

Landscapes™ well cover (Large)

Clear window well cover designed to fit Landscapes™ No-Maintenance Window Well (Large).

Each or 10/box

WW-42145



Standard Galvanized Window Wells

Standard Metal Wells



Area Well — Round Type
Inside Width 37" - Projection 16"

- 12", 24", 30", 36" Heights and foundation vent area wells also have rounded bottom corners for extra safety.
- Stamped from single steel sheet
- Bright finish - reflects light into basement
- Holes in flanges for bolting to wall
- Deep corrugation stiffens against back fill
- All back filling should be done gradually to prevent excessive pressure against area well
- Minimum G-60 galvanized coating

AREA WELL STANDARD INSIDE WIDTH — 37" ROUND TYPE — GALVANIZED STEEL

Model	Nominal Height	Weight Each lbs.
WWG-00012	12"	7
WWG-00024	24"	13
WWG-00030	30"	16
WWG-00036	36"	20
Sold in 5 per bundle		



Foundation Vent Area Well
Inside Width 19½" - Projection 10"

FOUNDATION VENT AREA WELL ROUND TYPE — GALVANIZED STEEL

Model	Nominal Height	Weight Each lbs.
WWG-00010	12"	5
Sold in 10 pack bundle		

Egress Style Casement Area Wells



WWG SERIES
Egress Casement Area Wells

Pictured with grate



WWGR Series Grate

*EGRESS CASEMENT AREA WELLS PAINTED WHITE GALVANIZED STEEL

Model	Height	Inside Width	Weight lbs.
WWG-423648	48"	42"	87
WWG-423660	60"	42"	106
WWG-423672	72"	42"	133

*All WWG Series = 36" Projection

EGRESS CASEMENT ACCESSORIES/GRATES

Model	Description	Inside Width
WWAL-00003	3 Rung Ladder 48-60"	12"
WWAL-00004	4 Rung Ladder 72-84"	12"
WWGR-04236	Egress Metal Grate	42"

Area Well-Standard/Vent Grates

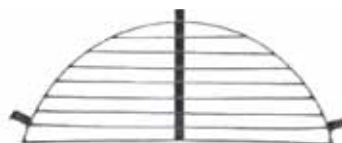

WWGR-00100
Area Well Grate



WWGF-00200
Foundation Vent Grate

STEEL GRATES ROUND TYPE

Model	Inside Width	Weight Each lbs.
WWGR-00100	37"	10
WWGF-00200	19.5"	3½

Concrete Products

Control-Joint Systems

Mar-flex Control-Joint Systems



The Mar-flex Control-Joint System is designed to eliminate "Random Shrinkage Cracks" by creating vertical control-joints on both sides of the foundation walls. To ensure further protection, a watertight, outside control-joint is created when filled with Mar-flex Waterstop Elastomeric Sealant and protected by Mar-flex Fiberglass Fabric Reinforcement. Residential basements require foundation walls that are watertight and waterproofed. The Mar-flex Control-Joint System provides an economical, easy to use system for eliminating "Random Shrinkage Cracks" which are generally unavoidable, uncontrollable, unsightly and will leak water if not planned for ahead of time.



- Isolates shrinkage cracking and eliminates "Random Shrinkage Cracking"
- Reusable plastic extrusion, which easily attaches to the edge of any concrete forming system
- Installed in pre-planned locations in the foundation wall
- The "V" point creates "inducement" for shrinkage cracking in a vertical line
- Available in 4' and 5' lengths, with 2" mounting flange
- Pre-punched for easy use with different brands of forms.

CJS-750 Control-Joint Extrusion

.750" Height for 8" wall thickness. 2" mounting flange. Includes 13 splice connectors.

25/box

CJS-42140 4' – 2" Flange
CJS-42150 5' – 2" Flange

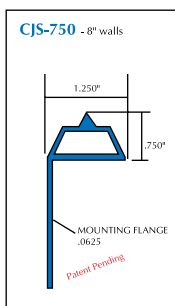

Waterstop Elastomeric Sealant

Highly elastomeric, rubber reinforced asphalt based membrane/trowel grade. Elastomeric properties allow for expansion and contraction of the control-joint while maintaining watertight adhesion.



CJS-42500
12/1qt. cartridge/box



CJS-42505
5 gallon bucket
Each or 42/Pallet

CJS-1250 Control-Joint Extrusion

1.250" Height for 10" and 12" wall thickness. 2" mounting flange. Includes 13 splice connectors.

25/box

CJS-42340 4' – 2" Flange
CJS-42350 5' – 2" Flange

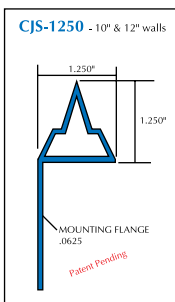

Fiberglass Fabric Reinforcement

Designed to be used in conjunction with elastomeric sealant to provide additional reinforcement to protect against backfill damage and soil compaction.

CJS-42525



Telescopic, Variable Flow Control Basement & Crawl Space Vents



Welcome to the future of foundation ventilation – and possibly the last vent you will ever need. Vortex by Mar-flex telescopic vents are available in two models to fit all your needs.

- Adjustable and telescopic for maximum versatility
- Less SKU/inventory headaches
- High-density polyethylene construction
- FEMA approved flood vents

VORTEX MANUAL

Vent features easy-to-access controls that allow user to adjust airflow. Adjusts from 7.5 to 10 inches and fits 8, 9 and 10 inch walls, nominal or full size. Dimensions: 19-1/4" W x 11-1/4" H Clear Vent Area-(CVA) 31.4 -Screen included.

Each or 60/Pallet

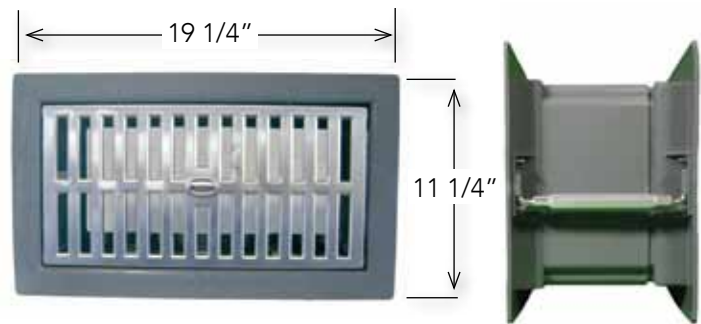

BCV-80150

REPLACEMENT MANUAL SCREEN

Replacement manual screen fits BCV-80050 and BCV-80150

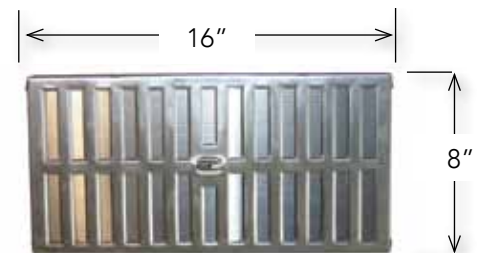

BCV-80200

VORTEX FLOOD VENT

Extruded Aluminum Vent Construction
Insect screen and heavy-duty rodent screen
Each vent covers up to 124 Sq. Ft. of area
Vents are always in the open position, allowing for fresh air ventilation
Adjusts from 7.5 to 10 inches and fits 8, 9 and 10 inch walls, nominal or full size
Clear Vent Area (CVA)-51
Dimensions: 19-1/4"W x 11-1/4"H
Each or 60/Pallet

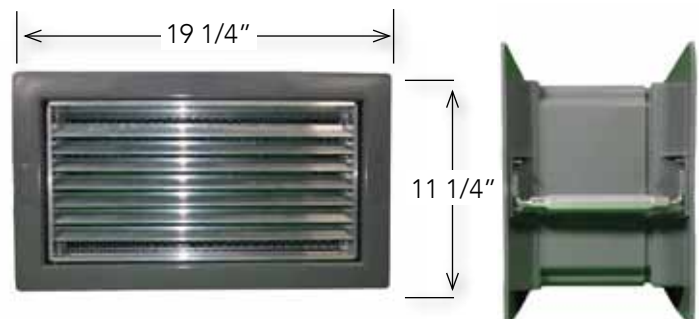

BCV-80160



Waterproofing
and Building
Products

Concrete Repair

Crack Injection & Repair Kits

Crack Injection & Repair Kits

30' Refillable Crack Injection Start Up Kit

Start-up kit provides basic materials and supplies for repair of cracks of approximately 30 lineal feet.

Kit Contents

- IAT-64105 - Crack Injection Gun (1)
- IA-68160 - Quick Set Surface Port Paste (3)
- IA-68100 - Quick Foam Fine (3)
- IA-68168 - Quick Set Urethane Adhesive (1)
- IA-68180 - Static Mixers (3)
- IA-68210 - Retaining Nuts (3)
- IA-68280 - Universal Surface/Corner Mounts (50)
- IA-68220 - Quick Hose Injection Assembly (4) Safety Glasses (1)
- Gloves (5 Pair) Plastic Towel (1) Wire Brush (1)
- Complete Instructional CD (1) Tool Box (1)



IAT-64100

Single Use Crack Repair Kit (Polyurethane/Epoxy)

The kit includes the materials and accessories for low-pressure injection and repair of approximately 8-10 lineal feet.

- Mar-flex Port Paste (1 jar 8oz. Part A, 1 jar 8oz. Part B)
- Wooden Sticks (2) Surface Ports and Caps (12)
- Mar-flex Injection Polyurethane/Epoxy Resin 1:1 (2 cartridges)
- 3/8":24 Mixing Nozzles (2) Injection Hose Assembly with plastic shut-off valve (1) Latex Gloves (2 Pair) Plastic Trowel (1)
- Wire Brush (1) Drop Cloth (1) Complete Instructional CD (1)
- Tool required: Standard Caulking Gun



IAT-64250 Polyurethane Repair Kit
IAT-64255 Epoxy Repair Kit

Staple Kit - Single/Triple

Structural cracks in concrete are caused by movement in the foundation, resulting in long-term moving and fatiguing of concrete. Horizontal cracks, or cracks wider than a quarter of an inch are general signs of a structural crack. Because the crack was initially caused by stress resulting from movement of the foundation, epoxy works to seal the crack, but by itself epoxy will not prevent further foundation cracking. The use of carbon staples provide the necessary reinforcement. By cross-stitching with countersunk staples within the foundation crack area, movement and fatigue are eliminated and improves long-term performance of repair material. Mar-flex's Staple Repair Kits are fully equipped with the components needed to provide the necessary reinforcement within the foundation crack area to improve long-term performance of repair material.

The Single - Staple Kit is designed to reinforce up to 10' of lineal crack.



IA-68166

The Triple - Staple Kit is designed to reinforce up to 30' of lineal crack.

IA-68167

Kit Contents:

- Carbon fiber staples - Single - (10), Triple (30)
- Tubeset of hi-mod gel - Single - (1), Triple (3)
- Green sulzer mixers - Single (2), Triple (6)

Urethanes

Quick Foam Fine Urethane (2 Part)

Quick Foam Fine is a hydrophobic polyurethane liquid with a 600 cps. Designed for water infiltration or ex-filtration. Cartridges contain product and catalyst that once introduced to water, reacts forming a closed cell barrier that prevents water infiltration. Designed to be used on cracks that are hairline and larger.

6 (1:1 cartridges)/box
Mixing nozzle IA-68180, and
retaining nut IA-68210 recommended



IA-68100

Quick Foam Broad Urethane (1 Part)

Quick Foam Broad is a hydrophilic polyurethane liquid with a 100 cps. Designed for water infiltration or ex-filtration. The dual cartridge comes with one side empty. Water is placed in the empty side and then when mixed with water, the product reacts within 30 seconds, creating a closed cell-barrier that prevents water infiltration. Best suited for cracks that are 1/8" or wider which are actively leaking.

6 (1:0 cartridges)/box
Mixing nozzle IA-68180, and
retaining nut IA-68210 recommended



IA-68120

Quick Set Adhesive Urethane

Designed for bonding, sealing, and repairing a wide range of properly prepared substrates including difficult to adhere to plastics, metals and concrete. Recommended for use as a concrete crack surface sealer (and to secure injection ports). It can also be used as a blow hole repair material and fast setting surface port adhesive. Quick curing, has three minute working time.



IA-68168

Port Paste/Epoxies

Quick Set Surface Port Paste

Quick Set Surface Port Paste is a 2 component smooth epoxy adhesive designed to seal the surface of a crack and to attach ports to masonry surfaces.

6 (1:1 cartridges)/box



IA-68160

Quick Set Surface Seal & Peel

Quick Set Surface Seal & Peel is a two component, solvent free, paste adhesive. It is used as a fast-curing removable surface sealer and to attach ports in epoxy and urethane foam crack repair. Cured product does not require sanding or grinding for removal from the wall.

6 (1:1 cartridges)/box



IA-68165

Low Viscosity Epoxy Crack Filler

Low viscosity & moisture insensitivity makes this an excellent product for the injection of dry or damp cracks. With a 200 cps it is designed for cracks that are hairline and larger.

8 (2:1 cartridges)/box
Mixing nozzle IA-68190, and retaining nut
IA-68210 recommended



IA-68140

Anchor Epoxy

High strength, fast setting, 2-component epoxy adhesive. 100% solids. Ideal for anchoring bolts, dowels and reinforcing rebar in concrete.

12 (1:1 cartridges)/box
12 static mixing nozzles and
retaining nuts included.



IA-68170

Concrete Repair

Injection Ports & Accessories

Injection Ports & Accessories

Universal Surface/Corner Mounts

Mounts are designed for surface/corner mounted low pressure crack injection. Surface/corner ports are suitable for both epoxy and urethane materials. Flush mounts to both flat and corner concrete surfaces.



250/box

IA-68280

1/4" : 24 Quick Mix Static Mixer

Static mixers designed to be used with cartridge systems. Recommended to be used with Quick Foam Fine (IA-68100), Quick Foam Broad (IA-68120)

24/box



IA-68180

1/4" : 32 Quick Mix Static Mixer

Static mixers designed to be used with cartridge systems. Recommended to be used with Low Viscosity Epoxy Crack Filler (IA-68140).

24/box



IA-68190

Retaining Nuts

Threaded nuts to hold mixing nozzle onto dual cartridge during crack injection process.



10/bag

IA-68210

Flexible Quick Hose Injection Assembly

Flexible hose assembly to get to those hard to reach injection ports. One end connects to mixing nozzle, other end attaches to port. Can be used with either epoxy or urethane materials.

IA-68220



10/box

Low-Pressure Drill-In Port

Designed to be used on hairline and actively leaking cracks. Suitable for use with static mixers. Length is 3-3/4". Requires a 5/8" diameter drilled hole. Internal ball bearing prevents back-flow of material during injection.



IA-68230

Crack Injection Gun Professional/Economy

Easy front loading with rear tube seals to prevent leaking. Kit included to convert gun from 1:1 to 2:1 applications.

IAT-64105 Professional
IAT-64114 Economy



Putty Knives

1-1/2" plastic, disposable putty knives. Ideal for hand mixing and applying surface port paste.

25/box

IAT-64210



Stir Dish

Clear stir dishes, suitable for mixing surface port paste.

200/box

IAT-64215



Wall Preparation Brush

Composite handle wire brush removes loose and scaled material from both smooth and rough masonry surfaces.

IAT-64225



Hypo-Allergenic Gloves

Ambidextrous, disposable latex gloves ideal for use with Crack Injection materials. 6 mil Nitrile 100 pieces/box

IAT-64240



Material Handling

Maintenance Items

Complete Transfer Pump Utilizing Parts

- 1:1 Transfer Pump MH-16200,
- 3/4" Quick Disconnect Female SA-08520,
- Transfer Pump Hose MI-12520



1:1 Transfer Pump

Graco 1:1 Fast Flo® transfer pump conveniently transfers material from 55 gallon drums to tank. Made of carbon steel.



MH-16200

Transfer Pump Extension Tube

Transfer pump extension tube for 330 gallon tote.



MH-16205

55 Gallon Drum Band Heater

120V, 3" wide heater that wraps around a 55 gallon metal drum, includes a 6' three prong power cord and a built-in thermostat with temperature range settings of 50° to 400° F.



MH-16310

Heavy-Duty Drum Heater

120V metal drum band heater. Equipped with two thermostat ranges that include three wattage settings, a spring loaded toggle clamp to snugly fit drum, and a 6' power cord with a three prong plug for grounded electrical operation.



MH-16320

55 Gallon Drum Blanket

Designed to maintain heat during transport to jobsite. Recommended for Water-based and Solvent-based products.



MH-16325

Equipment

Maintenance Kits / Speeflo Pumps & Parts

Maintenance Items

Hydra M 4000 Rebuild Kit

Contains seals, packings and check balls needed to rebuild lower unit for Speeflo Hydra M 4000™.



MI-11010

PowrTwin Rebuild Kit

Contains seals, packings and check balls needed to rebuild lower unit for Speeflo PowrTwin™ 8900 and 12000.



MI-11015

PowrTwin Replacement Filter

Replacement 5 mesh material filter with ball for Speeflo PowrTwin™ 8900 and 12000.



MI-11020



Questions?
Call Mar-flex Today!

800 498 1411

Spray Guns

Speeflo® S5 Spray Gun

Speeflo S5 is a standard size, contractor grade, air-less, stainless steel spray gun. Lightweight with three position trigger lock and working pressure of 5,000 psi.



SA-08020

Spray Wand/RAC Housing & Tip



Spray Gun Set-Up with Standard Swivel

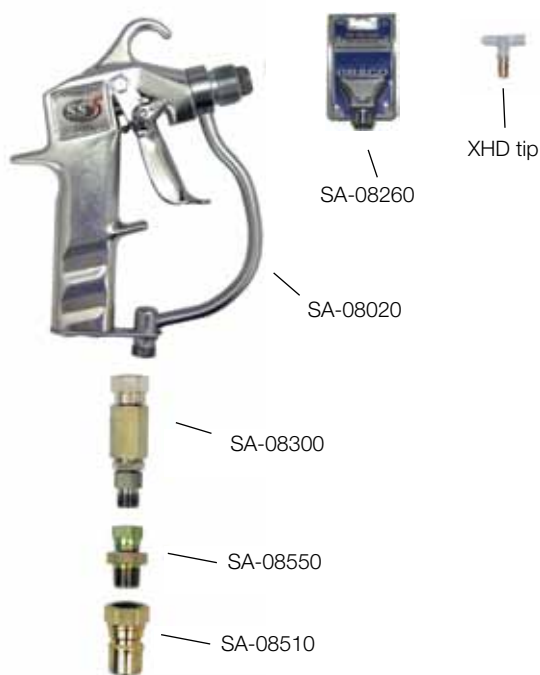

Spray Gun/Extension

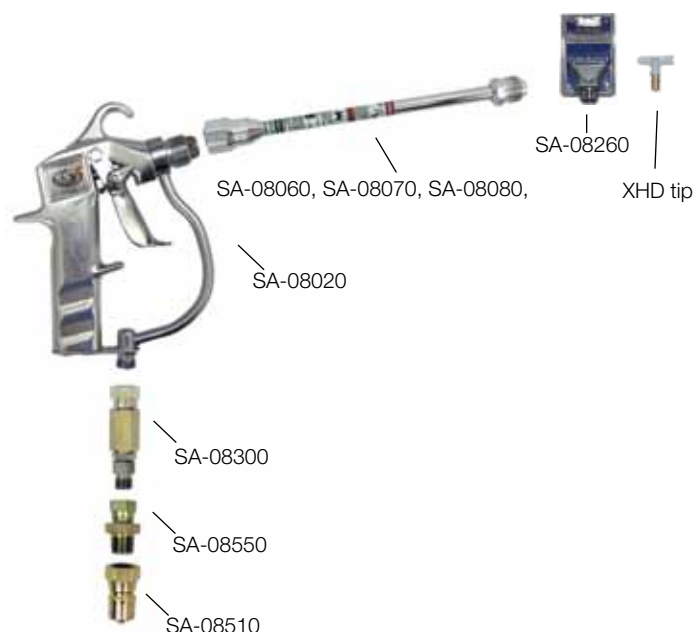

Equipment

Spray Guns / Spray Wands

Spray Accessories

Spray Gun Set up with a "Z" Swivel

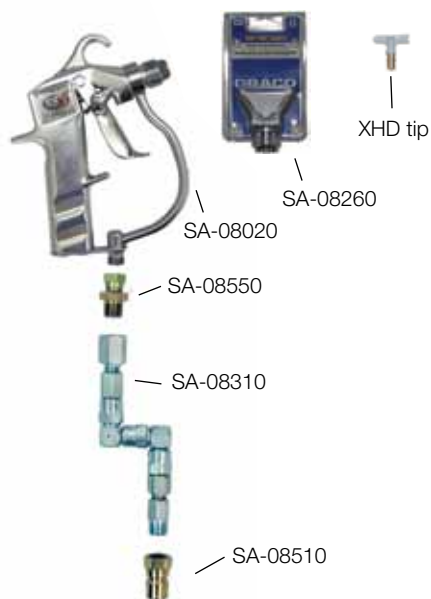

Gun Wand Extension 10"

An industry standard, extension designed to be used in conjunction with spray guns and Reverse-A-Clean™ housing and tips.



SA-08060

Gun Wand Extension 40"

An industry standard, extension designed to be used in conjunction with spray guns and Reverse-A-Clean™ housing and tips.



SA-08070

High Pressure Spray Wand 86"

Custom applicator wand designed for ease of application of waterproofing products. High pressure wand with ball valve release. Accepts a variety of tips for different viscosity materials. Made to use with Reverse-A-Clean™ housing and tip which are not included.



SA-08050

Gun Wand Extension 60"

An industry standard, extension designed to be used in conjunction with spray guns and Reverse-A-Clean™ housing and tips.



SA-08080

78" Wand Grip and Tube

This 78" wand is the replacement tube for the 86" high-pressure spray wand.



SA-08055

Angle Spray Nozzle Kit

Used on the 40" & 60" wand extensions and 86" high-pressure spray wand. Allows for 180° travel of spray tip, use in conjunction with the Reverse-A-Clean™ housing and tip.



SA-08085

Spray Accessories

Graco XHD Reverse-A-Clean™ Housing

Heavy-duty Reverse-A-Clean™ air-less spray tip housing assembly. Fits standard Reverse-A-Clean™ tips and standard spray gun fittings.



SA-08260

Graco XHD Tip/Housing Seal Kit

Replacement seals for XHD tip and Guard.

(5)/pack

SA-08263



Gun Wand Extension O-Ring

O-Ring that goes between the spray gun and the wand extension on the female end.

SA-08183



Graco XHD Heavy-Duty Reverse-A-Clean™ Air-less Spray Tip

The first number indicates the pattern width. This number is then doubled indicating the width of the spray pattern when held 12" away from wall. The second set of numbers indicates the orifice diameter. This number determines the rate of atomization, which can affect drying times and coverage rates.

SA-08272 XHD Reverse-A-Clean Tip #631
SA-08275 XHD Reverse-A-Clean Tip #635
SA-08279 XHD Reverse-A-Clean Tip #639
SA-08282 XHD Reverse-A-Clean Tip #727
SA-08283 XHD Reverse-A-Clean Tip #731
SA-08285 XHD Reverse-A-Clean Tip #735
SA-08287 XHD Reverse-A-Clean Tip #739



Contains 1 tip and 1 seal

Water-based Tip Recommendations:

Tip #631-635, #731, #735 - Mar-flex 5000 WB or QuickSeal WB
Tip #727, #731 - Dampproofing WB

Solvent-based Tip Recommendations:

Tip #635, #735 - Mar-flex 5000 SB or QuickSeal SB
Tip #727, #731 - Dampproofing SB



Equipment

Spray Accessories/Spray Hoses

Spray Accessories

Spray Gun Swivel

Swivel designed for convenience and comfort of applicator. Alleviates kinks in hoses. Female end fits standard spray gun.

SA-08300



"Z" Spray Gun Swivel

"Z" spray gun swivel designed for ease of application and comfort of applicator's wrist and arms. Alleviates kinks in hoses by rotating 360° both horizontally and vertically.

SA-08310



Spray Wand Adapter

Spray wand tip adapter with a 7/8" thread.

Used to convert the 86" spray wand for use with a Reverse-A-Clean™ housing and spray tip.

SA-08320



3/8" High-Pressure Ball Valve 1/2" High-Pressure Ball Valve

SA-08340 3/8" female pipe thread.

SA-08345 1/2" female pipe thread.

SA-08340 SA-08345



Spray Hoses

3/8" X 25' Hose

Replacement hose for Mar-flex spray equipment excluding the Hydra M 4000.

3/8" inside diameter by 25' high-pressure air-less hose with 1/2" male JIC to 3/8" male pipe.



SA-08400

3/8" X 25' Hose with Insulation and Abrasion Sleeve

Replacement hose for Mar-flex spray equipment excluding the Hydra M 4000.

3/8" inside diameter by 25' high-pressure air-less hose with 1/2" male JIC to 3/8" male pipe, insulation and protective abrasion sleeve.



SA-08410

3/8" X 50' Hose

Replacement hose for Mar-flex spray equipment excluding the Hydra M 4000. 3/8" inside diameter by 50' high-pressure air-less extension hose with 3/8" male and female quick disconnects.



SA-08420

Spray Hoses

1/2" X 125' Hose

Replacement hose for Mar-flex spray equipment excluding the Hydra M 4000. 1/2" inside diameter by 125' high-pressure air-less hose with 1/2" male pipe to 1/2" female JIC.



SA-08440

Hose Insulation

150' of hose insulation. Helps maintain proper temperature of product. Fits all of our spray hoses available from Mar-flex, use in conjunction with abrasion sleeve.



SA-08460

1/2" X 125' Hose with Insulation and Abrasion Sleeve

Replacement hose for Mar-flex spray equipment excluding the Hydra M 4000. 1/2" inside diameter by 125' high-pressure air-less hose with 1/2" male pipe to 1/2" female JIC, insulation and protective abrasion sleeve.



SA-08450

Abrasion Sleeve

250' of abrasion sleeve. Use in conjunction with hose insulation, protects hose from job site damage.



SA-08470

Equipment

Spray Hoses

Spray Hoses

3/8" X 50' Hose with Insulation and Abrasion Sleeve

Replacement hose for Mar-flex spray equipment excluding the Hydra M 4000. 3/8" inside diameter by 50' high-pressure air less extension hose with 3/8" male and female quick disconnects, insulation and protective abrasion sleeve.



SA-08430

Hydra M 4000 Hoses

3/8" X 25' Hose with Insulation and Abrasion Sleeve - High-Pressure

Hydra M 4000 replacement hose. 3/8" inside diameter by 25' 5,000 psi air-less hose with 1/2" male JIC to 1/2" male pipe, insulation and protective abrasion sleeve. Designed to be used with Hydra M 4000.



SA-08415

1/2" X 125' Hose with Insulation and Abrasion Sleeve - High-Pressure

Hydra M 4000 replacement hose. 1/2" inside diameter by 125' 5,000 psi air-less hose with 1/2" male pipe to 1/2" female JIC, insulation and protective abrasion sleeve. Designed to be used with the Hydra M 4000.



SA-08455

Spray Hose Connectors

Quick Disconnect Female

Quick disconnect female to be used in conjunction with quick disconnect male.

SA-08500 3/8"
SA-08514 1/2"
SA-08520 3/4"



SA-08500 SA-08514 SA-08520

3/8" Male Pipe to 3/8" Male Pipe Connector

SA-08555 Connects 3/8" quick disconnect male to 3/8" ball valve.



SA-08555

Quick Disconnect Male

Quick disconnect male to be used in conjunction with quick disconnect female.

SA-08510 3/8"
SA-08518 1/2"
SA-08530 3/4"



SA-08510 SA-08518 SA-08530

1/4" Female Pipe to 3/8" Male Pipe

Connects 1/4" end of 86" spray wand to 3/8" ball valve.



SA-08565

Female JIC to Male Pipe Connector

Connects spray gun swivel to standard spray gun.

SA-08550 1/4" Female JIC to 3/8" Male Pipe



SA-08550



Questions?
Call Mar-flex Today!

800 498 1411

Equipment

Assorted Parts

Maintenance Items

Pump Lubricant

Lubrication for center shaft piston for all spray equipment & 1:1 Fast Flo® pump. Helps to prevent material from adhering to the pump piston rod.

16 oz. bottle



MI-12350

Electric Hose Reel

Capable of holding up to 150' of hose. Includes high-pressure hose reel swivel.



MI-12390 – Solvent-based Hose Reel

MI-12395 – Water-based Hose Reel

Hose Reel Replacement Button

Replacement rewind button for electric hose reel.



MI-12415

DC Hose Reel Replacement Motor

12V DC hose reel replacement motor. Fits electric hose reels.



MI-12417

High-Pressure Hose Reel Swivel

Connects hose to electric hose reel to prevent kinks in hose; swivels 360°.



MI-12420

Heat Exchanger

Designed to elevate the temperature of waterproofing materials to be sprayed.



MI-12425 – Solvent-based Heat Exchanger

MI-12428 – Water-based Heat Exchanger

Pressure Gauge

Replacement pressure gauge for Mar-flex Spray Units.

MI-12455 – Pro Plus (SE-06100)

MI-12458 – Pro Series Water-based Spray Unit (SE-05200 & SE-05250)

MI-12460 – HotShot, WaterHog & SE-06110



Maintenance Items

Remote Temperature Gauge

Designed for use with HotShot and WaterHog.

MI-12465 – LED Remote Temperature Gauge



Temperature Gauge



3" Tank Gauge
MI-12470



2" Spray Gauge
MI-12480

GRACO 1:1 FAST FLO® Pump Air Rebuild Kit

Rebuild kit for air motor unit.
Includes seals and gaskets.

MI-12500



GRACO 1:1 FAST FLO® Transfer Pump Lower- Rebuild Kit

Rebuild kit for lower unit.
Includes seals and gaskets.

MI-12510



Transfer Pump Hose

24' replacement hose for
1:1 transfer pump (MH-16200).

MI-12520



SpeeFlo® S5 Spray Gun Repair Kit

Designed for repairing spray gun
when seepage of material occurs
and springs are weakened.
Tungsten carbide ball valve
and seat replacement.

MI-12620



SpeeFlo® S5 Spray Gun Repack Tool

Assists in installing gun repair kit (MI-12620).
Sleeve protects packings on needle, allowing seals
to slide in.

MI-12625



Safety & Protective Equipment

Hooded Coverall

Hooded coverall, durable, breathable protection with elastic arm and leg bands.

25/box



S/PE-56150L (Large)
S/PE-56150XL (Extra Large)
S/PE-56150XXL (Extra-Extra Large)

Double Dipped PVC Gloves

Double dipped PVC gloves provide protection from solvents, resins, paints and dyes.

12 pair/pack



S/PE-56300

Shoe Covers

One size fits most, slips easily over shoes. Prevents tracking of material onto clean floors. Excellent for crack repair.

50/box

S/PE-56175



PVC Gloves

Inexpensive, multi-use, general purpose utility gloves with full plastic coating over the entire palm providing enhanced protection and longer wear.

12 pair/pack.



S/PE-56305

Particulate Respirators

Particulate respirator is NIOSH certified under CFR84 regulation to have filter efficiency level of 95% or greater against particulate aerosols free of oil. Up to 10X PEL. Exhale valve lets workers breath easy and stay cool.

10/box

S/PE-56400



Safety & Protective Equipment

**Complete respirator utilizing parts
8000 Respirator Face Piece S/PE-56410,
Organic Vapor Cartridge S/PE-56415,
P-100 Particulate Filter S/PE-56420 and
Hepa Piggy Back Adaptor S/PE-56425.**



P-100 Particulate Filter

P-100 particulate filter protects against dusts, fumes, mists, radio nuclides, radon daughters and asbestos containing dusts and mists.

5 pair/box



8000 Respirator Face Piece

Soft, durable half face piece conforms to the contour of your face.



Hepa Piggy Back Adaptor

Hepa piggy back adaptor.

5 pair/box



Organic Vapor Cartridge

Organic vapor cartridge.

5 pair/box





Questions?
Call Mar-flex Today!

800 498 1411

Contractor Supplies

Accessories/Clean Up

Applicator Items

Wet Mil Gauge

Standard measuring tool for gauging proper thickness of spray-applied membranes.

10/pack



AI-28110

BreakAway Knives

Disposable knives, great for cutting drainage board. Just BreakAway blade as needed to obtain a new cutting edge.

25/box



AI-28130

Clean Up

Orange 90 Cleaner

Multi-purpose cleaner, excellent for cleanup of asphalt based products.



ACI-32110

5 Gallon Bucket
Each or 36/Pallet

Mar-flex Freight Zones

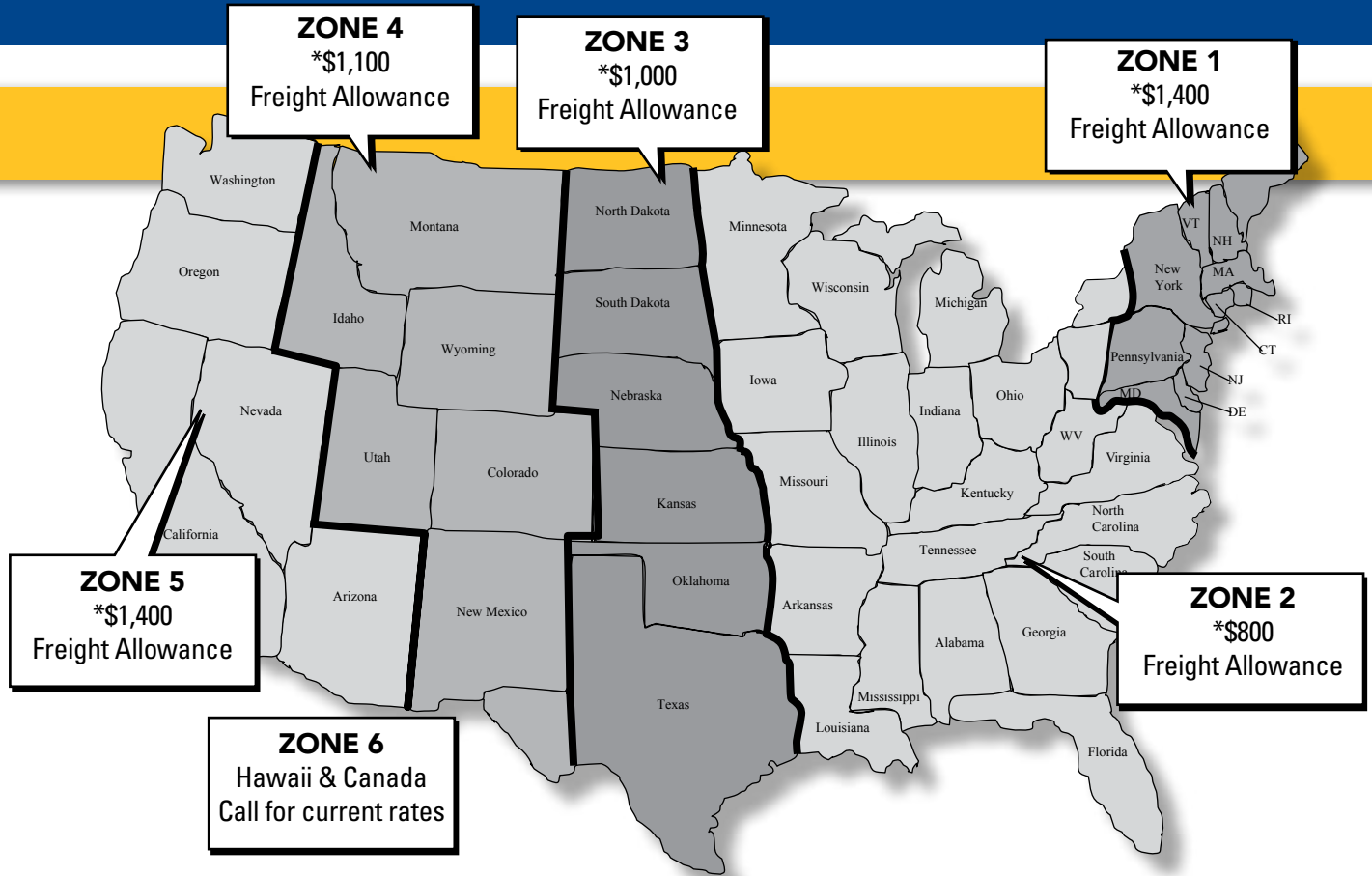

* Regardless of order size, we will always locate the best shipping terms to meet your timing and delivery requirements. If your total order exceeds \$24,000 and fits on a single truckload, the freight allowance will be given toward the actual cost of the shipment.

Credit Terms & Conditions

Credit Terms are Net 30 subject to approval (unless otherwise noted). Any amount remaining unpaid after such date will incur a service charge of 1.5% (monthly) on the unpaid balance, until paid in full, plus any and all collections costs and attorney fees incurred to collect unpaid balances.

Sales and/or use taxes will be collected in the following states: Illinois, Indiana, Ohio, Pennsylvania and Tennessee. For purchases shipped to other states, taxes are the responsibility of the purchaser. The collection of sales and/or use taxes is subject to change in order to comply with state regulations. All orders are subject to acceptance.

Every effort has been made to ensure the accuracy of the information contained in this catalog. Because of our constant efforts to offer the very best products, we reserve the right to change product specifications and/or prices without notice.

Return Policy

We will normally accept returned products under the following conditions:

- Prior written authorization including RGA number from Mar-flex Waterproofing Products is obtained.
- Products must be returned within 30 days from the original date of the invoice.
- Products must be in new and saleable condition.
- Products must be normal stock for us (not special or custom order).
- A 25% restocking fee plus return freight costs will be deducted from any credit.
- Returns are not accepted on electrical replacement parts.
- See water-base return policy on page 15 of our pricelists

F.O.B. Carlisle, Ohio 45005

Mar-flex® Product Catalog

More Products, More Solutions

Commercial	4-12	Egress Window Wells, Window Wells	29-33
Air Barrier Systems	4-5	Rhinowells™	29
Waterproofing	7	Stonewells™	30
Mar-flex ProVention 363™	7	Modularwells™	31
Dampproofing	8	Landscapes™	32
Mar-flex Moisture Block 361™	8	Standard Metal Well/ Egress Casement	33
Drainage Board & Rolls	9-11	Concrete Products	34-35
Shockwave.....	9	Control Joint Systems	34
Geo Mat "C" Drain	10	Foundation / Crawl Space/Flood Vents	35
Neofoam Insulation Board	11	Concrete Repair	36-38
Concrete Brick Sealer	12	Crack Injection Kits	36
Residential & Multi-family	13-34	Concrete Structural Repair Kits	36
Waterproofing & Dampproofing	13-22	Crack Injection Supplies	38-39
Mar-flex 5000™	14-15	Equipment	39-49
Mar-flex QuickSeal™	16-17	Material Handling.....	39
Mar-flex FUSION™	18-20	Maintenance Kits/Accessories	40-49
Residential Dampproofing	21-22	Contractor Supplies	50-52
Drainage & Insulation Boards & Rolls	23-27	Safety	50-51
ShockWave™	23	Accessories	52
Drain & Dry with Ecosé™ Technology	24	Cleaning.....	52
Geo-Mat™	25-27	Freight Zones	53
Composite Drainage Rolls/Accessories	26-27	Index	54
		Order Form	55

ORDER FORM

COPY AND FAX TO
513-422-7282 or email: info@mar-flex.com

OR CALL TOLL FREE 1-800-498-1411

Hours: Monday-Friday 8:00 a.m. - 5:00 p.m. E.S.T.

1. SOLD TO:	2. SHIP TO: (If different than #1)
Company Name:	Company Name:
Street Address:	Street Address:
City/State/Zip:	City/State/Zip:
Phone:	Phone:
Buyers Name/Title:	

Quantity	Item #	Item Description	Unit Price	Total Price

SHIPPING POLICY

Your order is shipped from the nearest Mar-flex location or dealer. UPS is used whenever possible. However, should your order exceed UPS size or weight limits, "Common Carrier" (LTL) will be selected and generally has a 48hr turnaround. Back ordered items to ship F.O.B. from origin.

RUSH SHIPMENTS/SPECIAL INSTRUCTIONS

Please request UPS Next Day Air, 2nd or 3rd Day, preferred truck line, or special instructions. We will promptly take care of your needs.

Subtotal

Tax

Shipping

Total Amount

Call for
options &
amounts

CREDIT TERMS & CONDITIONS

Credit Terms are net 30 subject to approval (unless otherwise noted). Any amount remaining unpaid after such date will incur a service charge of 1.5% (monthly) on the unpaid balance, until paid in full, plus any & all collection costs & attorney fees incurred to collect unpaid balances.

Sales and/or use taxes will be collected in the following states: Illinois, Indiana, Ohio, Pennsylvania and Tennessee. For purchases shipped to other states, taxes are the responsibility of the purchaser. The collection of sales and/or use taxes is subject to change in order to comply with state regulations. All orders are subject to acceptance.

Every effort has been made to ensure the accuracy of the information contained in the Mar-flex catalog. However, because of our constant efforts to offer you the very best products we must reserve the right to change product specifications & prices without notice.

F.O.B. Carlisle, Ohio 45005

Return Policy

We will normally accept returned products under the following conditions:

- Prior written authorization including RGA number from Mar-flex is obtained
- The products are returned within 30 days from the original date of the invoice
- The products are in new & saleable condition
- The products are normal stock for us (not special or custom order)
- A 25% restocking fee plus freight will be added on all returns
- Returns not accepted on electrical replacement parts.



Mar-flex ships ground packages
using UPS whenever possible



Waterproofing
and Building
Products



Mar-flex offers the best waterproofing products in the industry.

Mar-flex® Waterproofing & Building Products

We are a USA family-owned innovative manufacturer of waterproofing foundation and air barrier products. We offer unsurpassed quality and reliability with time tested solutions for the building industry.

Everything you need to do the job right

Mar-flex goes the extra step to help you from start to finish with an array of products and accessories, egress and non-egress window wells, perimeter drainage, telescopic vents and control-joints. Architects and Contractors alike can rely on Mar-flex for:

- Technical specifications at Mar-flex.com
- Hands-on training right in your area
- Job site support
- Sales support to help your market
- LEED certifications
- Specifications and CAD details, available at Mar-flex.com

Mar-flex guarantee

Mar-flex guarantees quality and versatility — delivering solutions that go above and beyond what you would normally expect. Mar-flex offers a full range of products to perform the job from start to finish. All Mar-flex products are backed by warranties because we stand behind our manufacturing process.

Complete waterproofing systems

Mar-flex has set the industry standard for offering superior water-based and solvent-based waterproofing membranes, an extensive “green” product assortment, and a wide range of drainage and insulation boards to complete the job based on your markets’ needs.



Printed on recycled paper

Try the complete line of Mar-flex products:

Foundation Waterproofing | Waterproofing Membranes | Dampproofing Products | Concrete Repair
Concrete Anchor Epoxies | Drainage Boards | Egress Window Wells | Standard Window Wells
Sealers/Mastics | Control Joint Systems | Air Barrier Systems | Vortex Vents

Order Today! Contact Mar-flex for the dealer nearest you. 800-498-1411 | 513-422-7285 | Fax 513-422-7282 | Mar-flex.com

©2015 Mar-flex Waterproofing & Building Products. All rights reserved. 5000-8/2015

Lit. Item #CAT1
11/2015/2000